

PIF PAF 75



General data:

Casing: aluminium
Mounting: to the track 230V
Ingress protection IP: IP20
Operating temperature: from -40°C to +40°C
Lifetime L80B10: 100 000h

Electric data:

Nominal voltage: 220-240V AC
Nominal frequency: 50-60 Hz
Protection class: I
Reflector: Yes
Dimming: on-off, DALI (on request: POTENCJOMETR, CASAMBI))

Optical data:

Optical system: lens
Material: glass

Lighting data:

Light source: LED
Colour rendering index: CRI>90 (on request: CRI>95)
Tolerance of luminous flux: +/-10%

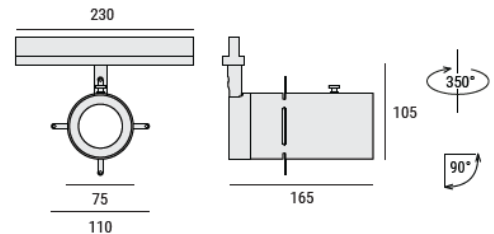

PIF-PAF LED framing projector. The use of appropriate framing accessories allows you to shaping the light according to individual needs. Thanks to the adjustable optics and framing, we manipulate the shape of the incident light, which allows us to precisely illuminate a given object, its part or image. PIF-PAF is designed to be mounted on a magnetic track (48V) or three-surface tracks (230V). Control: on/off, manual or DALI.

E- electronic

O- on-off

D- Dali



white
03

Black
05

C- colour

framing lenses

Catalogue code	Light flux	Power	Effectiveness	Color temperature	CRI/RA	Weight	Dimensions	Box dimensions
2053.02EC	1340lm	19W	71lm/W	2700K	≥90	0,8kg	Ø75x110 H=105mm	350x300x200mm
2053.03EC	1396lm	19W	73lm/W	3000K	≥90	0,8kg	Ø75x110 H=105mm	350x300x200mm
2053.04EC	1454lm	19W	77lm/W	4000K	≥90	0,8kg	Ø75x110 H=105mm	350x300x200mm

Accessories

GOBO handle - GOBO plate Ø55mm, cut-out pattern max. Ø22mm, GOBO not included

On request

