

## BALANCE Installation Manual

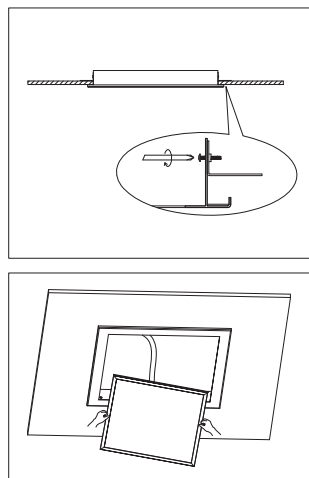

③ Fasten the frame into ceiling by screwing another 2 pcs clips on the other side of frame.

④ Feed the main AC wire in terminal block respectively.

⑤ Fix led panel light into the recessed frame.

⑥ Installation complete, turn on the power.

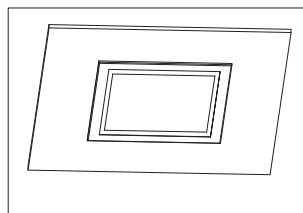
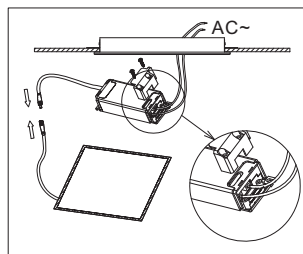

### Recessed with frame

① Open a hole according to the lamp cut out size.

② Open the accessory pack, fix the installation clips to the side of lamp.

③ Connect DC wire.

④ Fasten one side of clips with the ceiling.

⑤ Fasten the other side of clips.

⑥ Turn on the power, installation completed.

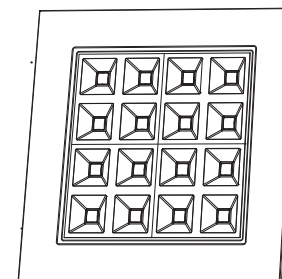
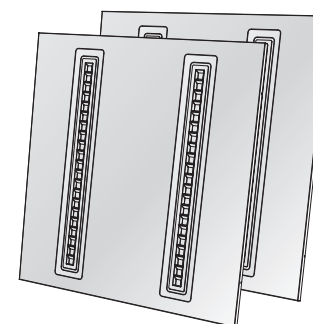

**Warning:** Input wire diameter  $\geq 0.75\text{mm}^2$ .  
Product modification and improper installation are not valid for warranty!

**Note:** If the diffused material LGP is constructed from quality PS material, while discoloration of LED panel is easily generated with exposure to sunlight/UV. In general installation area, places without sunlight/UV, PS is strong enough to support. However, sunlight/UV can cause discoloration, under this circumstance, we would recommend the use of LED panel made of PMMA material. Please note warranty does not cover discoloration of diffused material.

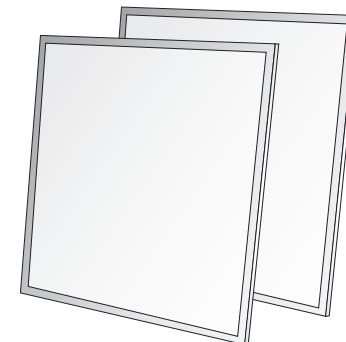

## Installation For Plaster Ceilings

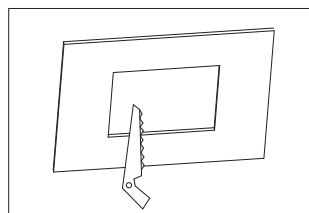

① Open the ceiling with a needed hole.

② Assemble the spring on the panel.

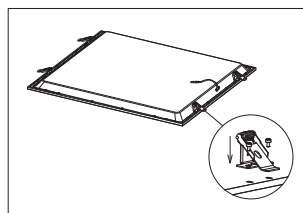

③ Make the springs in a vertical direction with the panel and make it fit the cut hole.

④ Make the springs in a horizontal direction with the panel and make sure they match well.

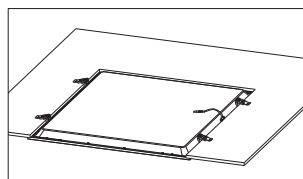
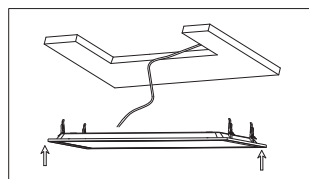

### Recessed Mounting(Clips)

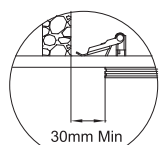
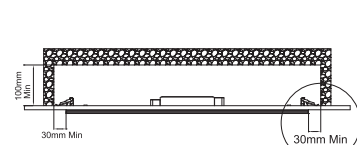

Clips should be purchased separately as an accessory

### Warning:

Input wire diameter  $\geq 0.75\text{mm}^2$ .  
Product modification and improper installation are not valid for warranty!

### Safety Instruction:

Basic safety precautions should always be followed when installing, including the following:

1. Read instructions carefully before installing.
2. This LED Panel requires professional installation and maintenance.
3. The power supply of the LED Panel should be powered by a dedicated external LED driver.
4. Disconnect the power supply before installing or maintenance.
5. Make sure the wires have been properly connected before powering on the device.
6. Ensure the product has enough space for heat dissipation.
7. Ensure the luminaries are never covered by any heat insulation mat or slim layer material at any time.
8. Dimmable version could be compatible with a wide range of recommended TRIAC dimmers.
9. IP40 for indoor use only, not for damp location; IP54 for indoor damp location.
10. Ambient Temperature:  $-10^{\circ}\text{C}$  to  $+45^{\circ}\text{C}$ ; Avoid direct sunlight.
11. Storage Conditions: Cool & dry conditions.

⑤ Through the steel wire into the wire cap, adjust the length of steel wire.

④ Twist the wire cap to fasten it into wire locking clips, feed the main AC wire.

⑤ Adjust the length of steel wires, connect the power supply.

## Safety Instruction:

1. Turn off power before installation or before doing any maintenance work.
  2. Do not install any luminaire near a heat source.
  3. For Indoor use.
  4. Do not exceed the nominal supply voltage or amperage ratings.
  5. All wiring and installation of this luminaire must adhere to local and national wiring rules eg AS/NZS 3000:2007 Amendment 2:2012
- Electrical Installation
6. Take care not to pull any electrical wires during unpacking as this may damage the connection.
  7. Lay out all the components on a smooth surface and make sure there are no components missing before assembling.
  8. To avoid injury or damage to the fitting, please ensure that power leads and screws are secure before connecting the power.
  9. Please keep instructions for future reference.

## Installation Procedure

### WARNING:

1. Switch off before installation.
2. Switch on only after complete installation and examination of the circuit.



### CAUTION:

Make sure that the mounting surface or structural member used for installation can support the weight of LED Panel.

### Lamp inspection before installation:

Take out the lamp from the box and put it in a flat table, if the lamp upwarps, please adjust the lamp with below steps before installation:

1. Press the opposite angles at the same time;
2. Press another two opposite angles at the same time, make sure the four angles are flat, then start the installation.

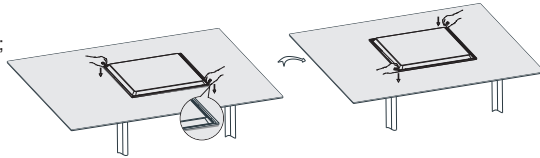

## Recessed

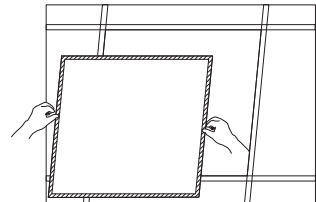

- ① Remove the ceiling plaster slab.

- ② Feed the main AC wire in driver terminal block respectively, connect the panel light and driver.

- ③ Fix the panel light into plaster ceiling.

- ④ Make sure the led panel light is firmly fixed, turn on the power.

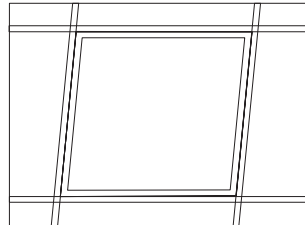
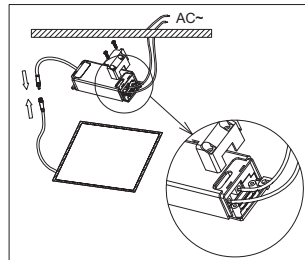

## Suspended

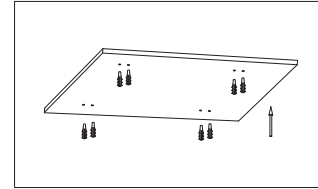

- ① Fix the anchor into target place on the ceiling.

- ② Fix the installation mount on the ceiling with plastic anchor.

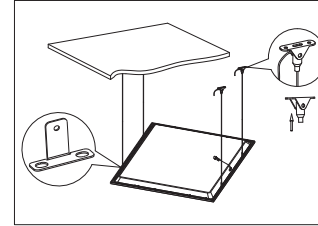

- ③ Hang the panel to ceiling with suspended installation kits, adjust the length of steel wires.

- ④ Feed the main AC wire in driver terminal block respectively, turn on the power.

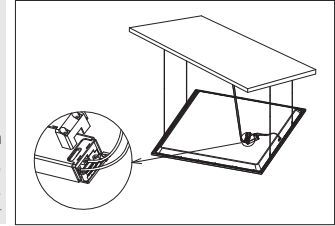
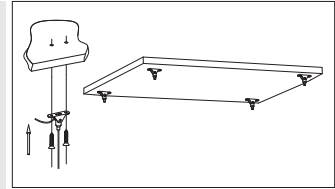

## Surface mounted

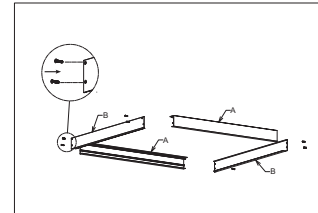

- ① Assemble the surface mounted frame and fix by screws.

- ② Knock the plastic anchor into ceiling, fix the surface mounted frame on the ceiling by screws.

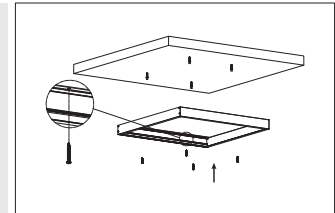

- ④ Fix the side frame back by screw.

- ③ Unscrew the side frame then take out, connect the panel light to power supply, insert the panel light into the frame.

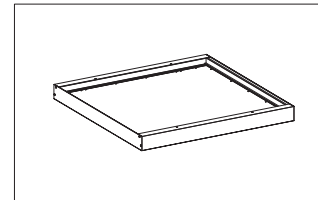

- ⑤ Make sure the frame and panel light are firmly fixed, turn on the power.

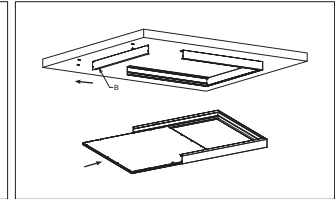
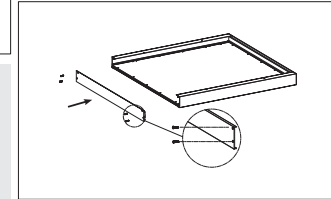

## Recessed with frame

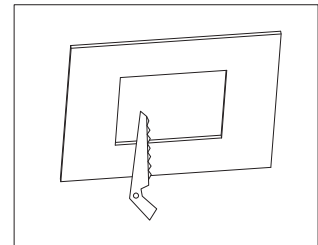

- ① Open a hole on ceiling according to cutout size of recessed frame.

- ② Fix 2pcs of clips to one side of frame by screw, then insert the frame into ceiling.

