

BINA

FARBMÖGLICHKEITEN & DIFFUSOR | COLOUR OPTIONS & DIFFUSOR

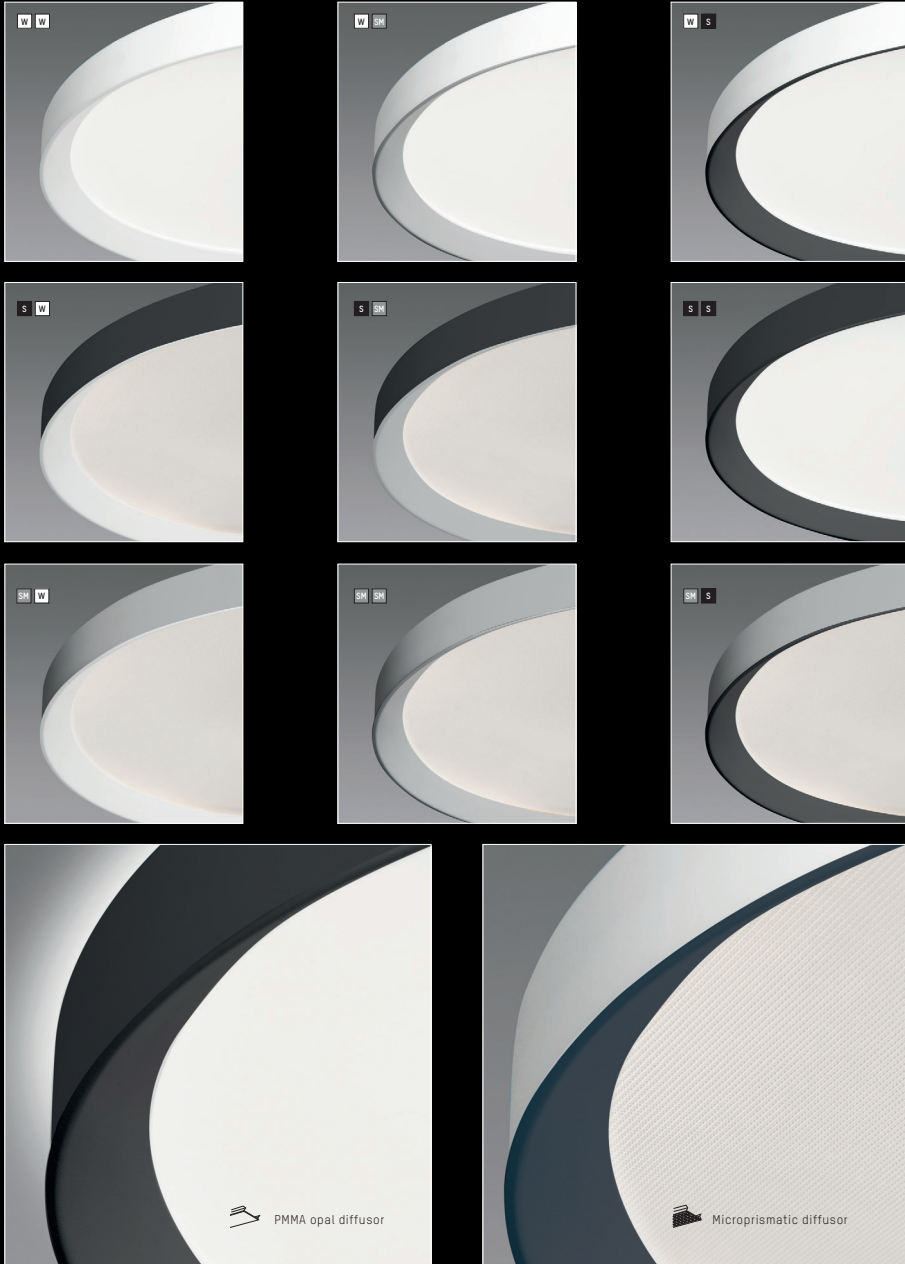

MONTAGEMÖGLICHKEITEN | MOUNTING OPTIONS

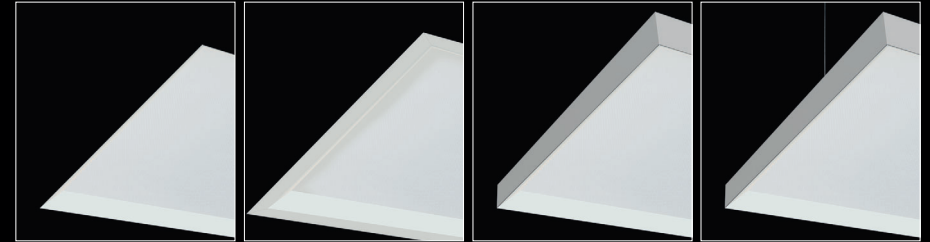

EINBAU RAHMENLOS | RECESSED TRIMLESS

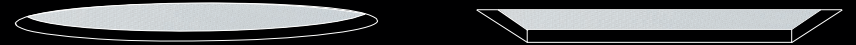

EINBAU MIT RAHMEN | RECESSED WITH FRAME



AUFBAU | SURFACE

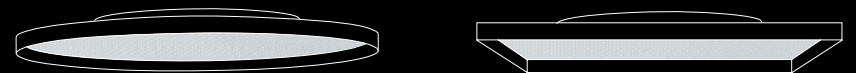

HÄNGELEUCHE | PENDANT

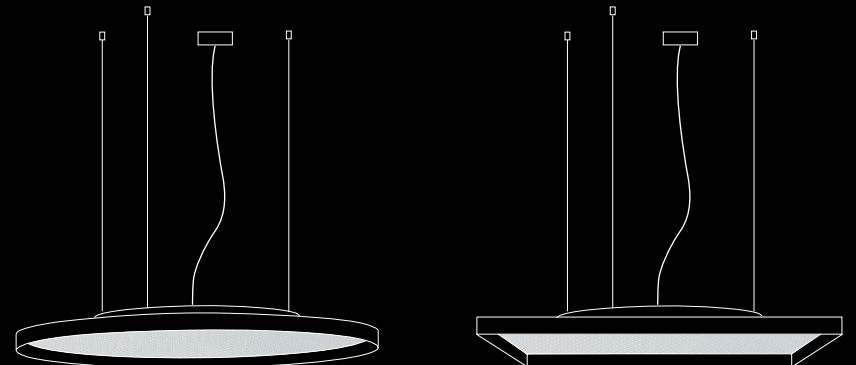

BINA

ZUSAMMENSETZUNG & DIMENSIONEN | COMPOSITIONS & DIMENSIONS

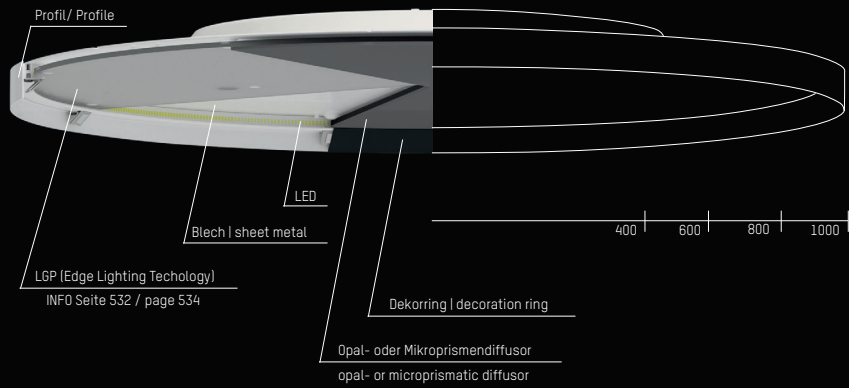

DETAIL | DETAIL

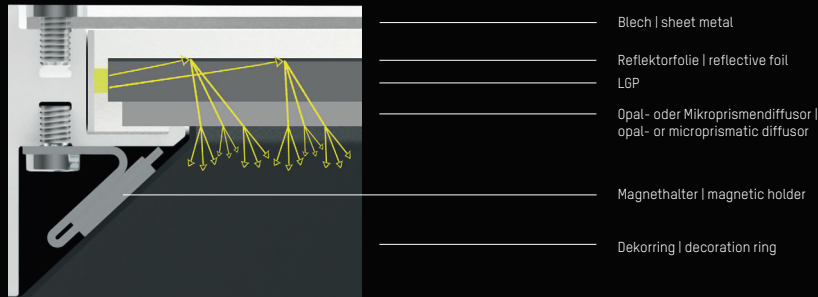

FIXIERUNG | FIXATION

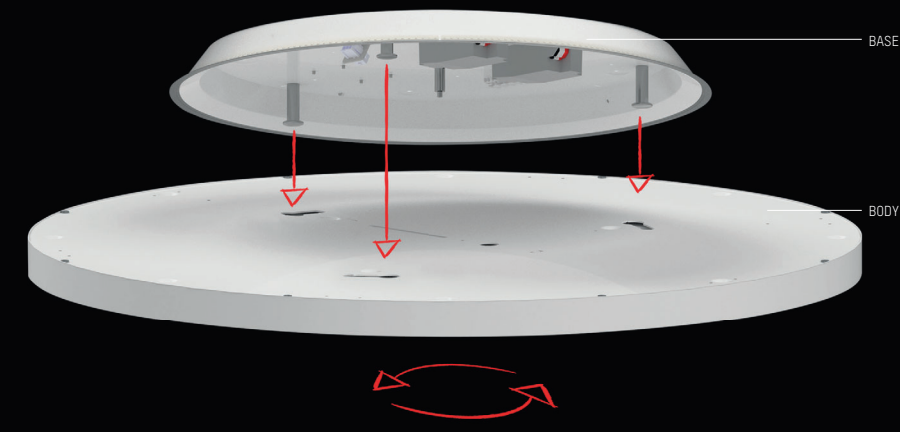

MONTAGE & DEMONTAGE | MOUNTING & DISMOUNTING

STEP 1 - push in luminaire

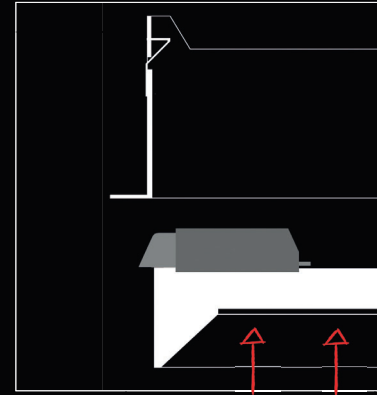

STEP 2 - push in luminaire (mounting device pushes back)

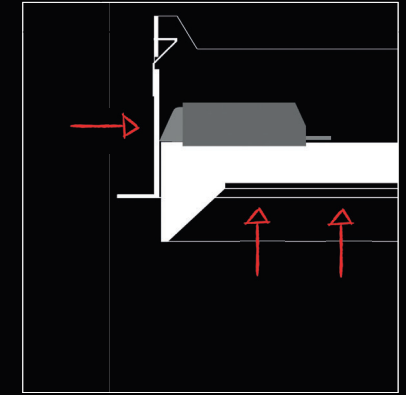

STEP 3 BELA FIXED (mounting device fixes the luminaire)

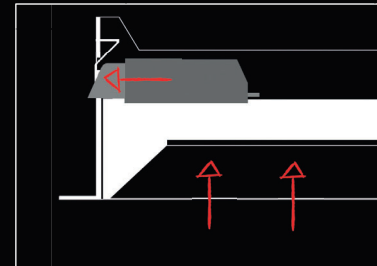

STEP 4 DEMONTAGE - push in luminaire (mounting device pushes back and fixes itself in place)

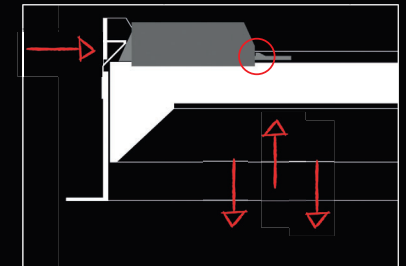

INNOVATIVE LIGHTING TECHNOLOGY, EXTRA-SLIM DESIGN

Modernste Edge-Lighting Technology durch speziell entwickelte Lichtleiterplatten vereint sich mit klarer Formsprache und schlankem Design zu einer funktionalen und variantenreichen Leuchtenfamilie. Die Produktfamilie ist als Baukastensystem konzipiert, sodass die Leuchten perfekt auf das Projekt abgestimmt werden können. Erhältlich sind Decken-, Einbau- und Pendelleuchten in unterschiedlichen Durchmessern von 400mm bis zu 1000mm sowie in direkt und direkt/indirekt strahlenden Versionen. Die perfekte Homogenität durch einen zurückversetzten, opalen oder mikroprismatischen Diffusor und ein schräg nach innen verlaufender Dekorring vervollständigen das ansprechende Design. Der Variantenreichtum schafft Abwechslung in der Raumgestaltung und ermöglicht ein spannendes Lichtkonzept innerhalb eines Raumes/Projektes.

Modern Edge-Lighting technology with specially developed light guide plates combines a clear design language with a slim style to create a functional and varied lighting family. The product family is designed as a modular system so that the luminaires can be perfectly matched to the project. The ceiling, recessed and pendant luminaires are available in different diameters from 400mm up to 1000mm as well as in direct or direct/indirect beam versions. The perfect homogeneity due to recessed opal or microprismatic diffusers in combination with the obliquely inward decorative ring complete the particularly appealing design. The wealth of variants creates variety in the interior design and enables an exciting lighting concept within a room or project.

Design: INHOUSE

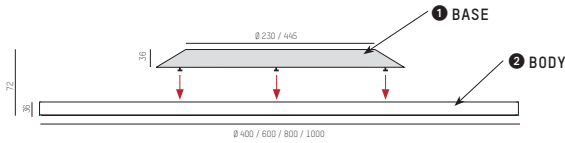
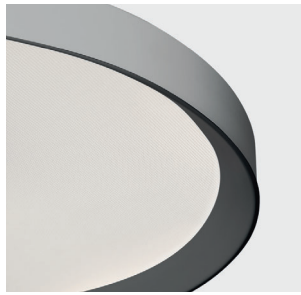

1 BETRIEBSBASIS / BASE

Leuchtenkörper separat ordern / Order body separately

BINA SD BASE

for Ø: 400 / 600mm for direct beam
220-240V AC



663-411010000XXY

BINA SDI BASE

for Ø: 800 / 1000mm for direct beam
220-240V AC



663-431010000XXY

BINA SDI BASE

for Ø: 400 / 600mm for direct / indirect beam
220-240V AC - CRI >80 - Binning SDCM 3

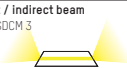

SYS 15W

lm	W2	lm	W3	lm	W4
663-41102001WXXY	1365	1415	1415	(lm indirect)	

BINA SDI BASE

for Ø: 800 / 1000mm for direct / indirect beam
220-240V AC - CRI >80 - Binning SDCM 3

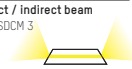

SYS 26W

lm	W2	lm	W3	lm	W4
663-43102001WXXY	3115	3225	3225	(lm indirect)	

ARTIKELNUMMER ERGÄNZEN / COMPLETE CODE

W = LICHTFARBE/LIGHT COLOUR
for indirect beam

XX = FARBE/COLOUR BASE

Y = DIMMBAR/DIMMABLE

W2	LED 2700K = 3
W3	LED 3000K = 9
W4	LED 4000K = 4

W	white = 05
S	black = 06
SM	silver matt = 04

S	switchable = 0
D	DALI dimm = d
AE	EMERGENCY 3h = e
AE	EMERGENCY 3h DALI Dimm = f

Superschlange Aufbauleuchte aus Aluminium
Pulverbeschichtet in weiß, schwarz oder silber matt
Direktabdeckung in opal oder mikropriamatisch
Dekoring in weiß, silber matt oder schwarz
Leuchte besteht aus 2 Teilen

Super-slim surface mounted luminaire in aluminium
white, black or silver matt powder-coated surface
Recessed direct cover, opal or micropriamatic
white, silver matt or black decoration ring
Luminaire consists of 2 parts

Lampada da soffitto a ingombro ridotto in alluminio
Verniciata a polvere in bianco, nero o grigio opaco
Copertura retrocessa opale o micropriamatica
Anello decorativo in nero, grigio opaco o bianco
Lampada composta da 2 parti

Applique extra-fine en aluminium
Finition laquée blanc, noir ou gris mat
Diffuseur en retrait opal ou micropriamatic
Anneau décoratif en noir, gris mat ou blanc
Luminaire composé de deux éléments

☐ = UGR < 19 (not for Ø 400mm)

TUNABLE WHITE auf Anfrage / on request

☐ = PMMA opal diffusor

☐ = Microprismatic diffusor

A** - A

IP 20 CE

2 LEUCHTENKÖRPER / BODY

Betriebsbasis separat ordern / Order base separately
CRI >80 - Binning SDCM 3

SYS 29W

Ø: 400mm	lm	W2	lm	W3	lm	W4
663-11100101WXXO	2270	2350	2350	☐		
663-11100201WXXO	2275	2355	2355	☐		

SYS 58W (PMMA)

SYS 51W (MICROPRISMA)

Ø: 800mm	lm	W2	lm	W3	lm	W4
663-13100101WXXO	6280	6505	6505	☐		
663-13100201WXXO	5775	5980	5980	☐		

SYS 38W (PMMA)

SYS 33W (MICROPRISMA)

SYS 76W

Ø: 600mm	lm	W2	lm	W3	lm	W4
663-12100101WXXO	3760	3895	3895	☐		
663-12100201WXXO	3365	3485	3485	☐		

Ø: 1000mm	lm	W2	lm	W3	lm	W4
663-14100101WXXO	8320	8615	8615	☐		
663-14100201WXXO	8345	8640	8640	☐		

ARTIKELNUMMER ERGÄNZEN / COMPLETE CODE

W = LICHTFARBE/LIGHT COLOUR
for direct beam

XX = FARBE/COLOUR BODY

W2	LED 2700K = 3
W3	LED 3000K = 9
W4	LED 4000K = 4

A	B	SM	SM	silver matt-silver matt = 44
SM	W	SM	W	silver matt-white = 45
SM	S	SM	S	silver matt-black = 46
SM	W	SM	SM	white-silver matt = 54
W	W	SM	W	white-white = 55
W	S	SM	W	white-black = 56
S	SM	SM	SM	black-silver matt = 64
S	W	SM	W	black-white = 65
S	S	SM	S	black-black = 66

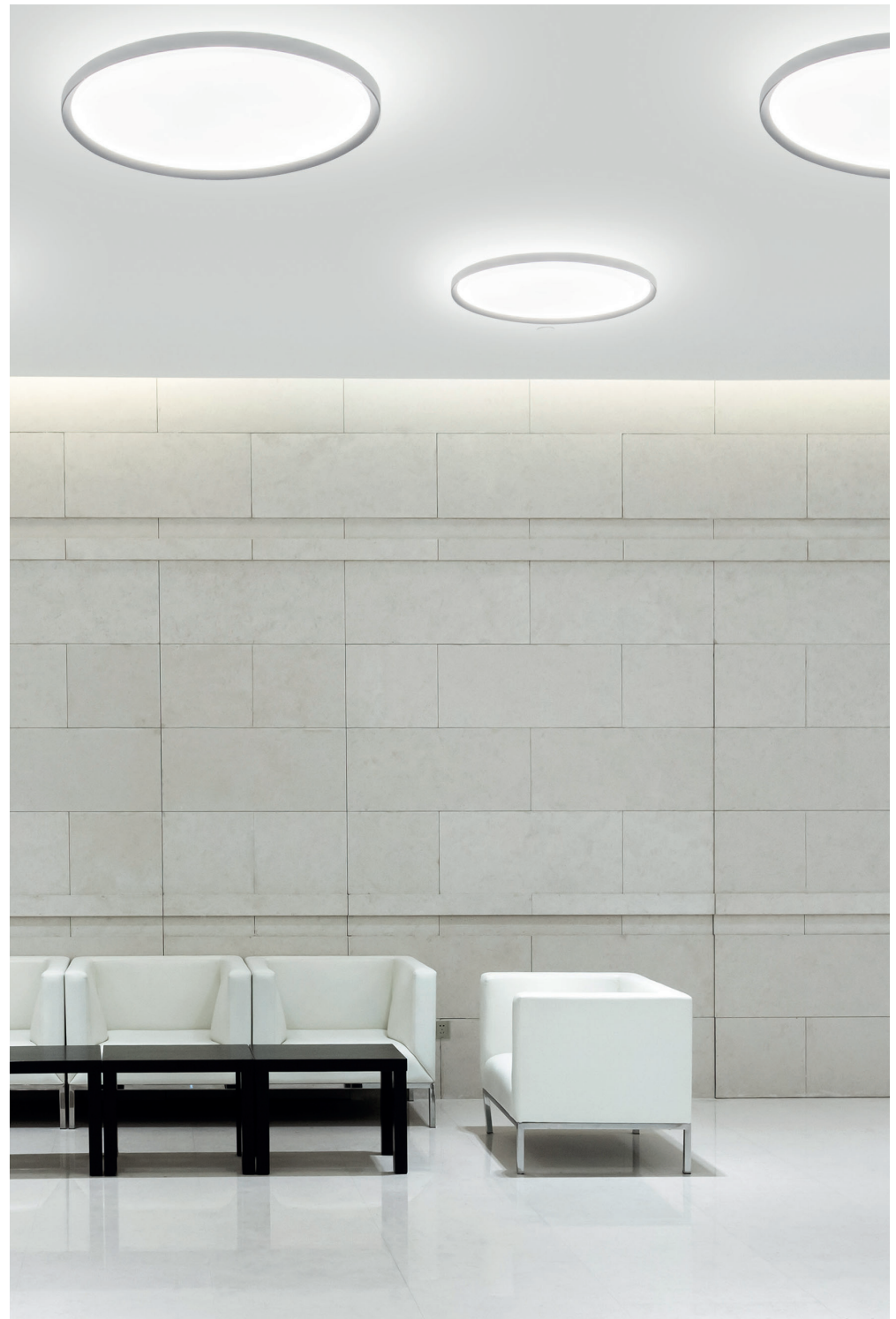

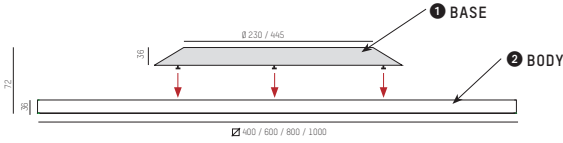
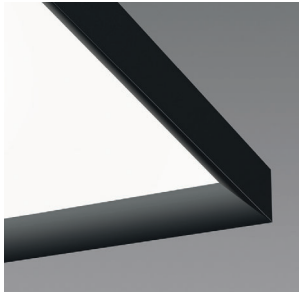
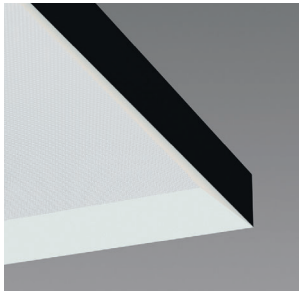

1 BETRIEBSBASIS / BASE

Leuchtenkörper separat ordern / Order body separately

BINA SD BASE

for \square : 400x400 / 600x600mm for direct beam

220-240V AC

663-411010000XXY

BINA SDI BASE

for \square : 800x800 / 1000x1000mm for direct beam

220-240V AC

663-431010000XXY

BINA SDI BASE

for \square : 400x400 / 600x600mm for direct-indirect beam

220-240V AC - CRI >80 - Binning SDCM 3

663-41102001WXXY

BINA SDI BASE

for \square : 800x800 / 1000x1000mm for direct-indirect beam

220-240V AC - CRI >80 - Binning SDCM 3

663-43102001WXXY

SYS 15W

lm	W2	lm	W3	lm	W4
663-41102001WXXY	1365	1415	1415	(lm indirect)	

SYS 26W

lm	W2	lm	W3	lm	W4
663-43102001WXXY	3115	3225	3225	(lm indirect)	

ARTIKELNUMMER ERGÄNZEN / COMPLETE CODE

W = LICHTFARBE/LIGHT COLOUR
for indirect beam

W2	LED 2700K = 3
W3	LED 3000K = 9
W4	LED 4000K = 4

XX = FARBE/COLOUR BASE

W	white = 05
S	black = 06
SM	silver matt = 04

Y = DIMMBAR/DIMMABLE

S	switchable = 0
D	DALI dimm = d
AE	EMERGENCY 3h = e
AE	EMERGENCY 3h DALI Dimm = f

Superschlankes Aufbauleuchte aus Aluminium
Pulverbeschichtet in weiß, schwarz oder silber matt
Direktabdeckung in opal oder mikropismatisch
Dekoring in weiß, silber matt oder schwarz
Leuchte besteht aus 2 Teilen

Super-slim surface mounted luminaire in aluminium
white, black or silver matt powder-coated surface
Recessed direct cover, opal or microprismatic
white, silver matt or black decoration ring
Luminaire consists of 2 parts

Lampada da soffitto a ingombro ridotto in alluminio
Verniciata a polvere in bianco, nero o grigio opaco
Copertura retrocessa opale o microprismatica
Anello decorativo in nero, grigio opaco o bianco
Lampada composta da 2 parti

Applique extra-fine en aluminium
Finition laquée blanc, noir ou gris mat
Diffuseur en retrait opal ou microprismatique
Anneau décoratif en noir, gris mat ou blanc
Luminaire composé de deux éléments

= UGR <19 (not for \square 400mm)

TUNABLE WHITE auf Anfrage / on request

= PMMA opal diffusor

= Microprismatic diffusor

A** - **A**

IP 20

2 LEUCHTENKÖRPER / BODY

Betriebsbasis separat ordern / Order base separately
CRI >80 - Binning SDCM 3

SYS 29W

\square : 400x400mm	lm	W2	lm	W3	lm	W4
663-21100101WXXO	2680	2775	2775			
663-21100201WXXO	2685	2780	2780			

SYS 58W

\square : 800x800mm	lm	W2	lm	W3	lm	W4
663-23100101WXXO	6410	6635	6635			
663-23100201WXXO	6315	6540	6540			

SYS 38W (PMMA)

\square : 600x600mm	lm	W2	lm	W3	lm	W4
663-22100101WXXO	3745	3875	3875			
663-22100201WXXO	3390	3510	3510			

SYS 33W (MICROPRISMA)

SYS 76W

\square : 1000x1000mm	lm	W2	lm	W3	lm	W4
663-24100101WXXO	8530	8835	8835			
663-24100201WXXO	8430	8730	8730			

ARTIKELNUMMER ERGÄNZEN / COMPLETE CODE

W = LICHTFARBE/LIGHT COLOUR
for direct beam

W2	LED 2700K = 3
W3	LED 3000K = 9
W4	LED 4000K = 4

XX = FARBE/COLOUR BODY

A	B	SH	SM	W	silver matt-silver matt = 44
SH	W	SM	W	silver matt-white = 45	
SH	S	SM	S	silver matt-black = 46	
W	SM	W	SM	white-silver matt = 54	
W	W	W	W	white-white = 55	
W	S	W	S	white-black = 56	
S	SM	S	SM	black-silver matt = 64	
S	W	S	W	black-white = 65	
S	S	S	S	black-black = 66	

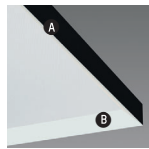

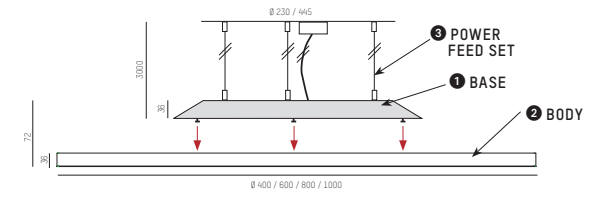

1 BETRIEBSBASIS / BASE
Leuchtenkörper und Einspeisungs-Set separat ordern / Order body and power feed set separately

BINA PD BASE for Ø: 400 / 600mm for direct beam 220-240V AC	BINA PD BASE for Ø: 800 / 1000mm for direct beam 220-240V AC
663-411010000XXY	663-431010000XXY

BINA PDI BASE for Ø: 400 / 600mm for direct / indirect beam 220-240V AC - CRI >80 - Binning SDCM 3	BINA PDI BASE for Ø: 800 / 1000mm for direct / indirect beam 220-240V AC - CRI >80 - Binning SDCM 3
---	--

SYS 15W	lm W2	lm W3	lm W4	SYS 26W	lm W2	lm W3	lm W4
663-41102001WXXY	1365	1415	1415 (lm indirect)	663-43102001WXXY	3115	3225	3225 (lm indirect)

ARTIKELNUMMER ERGÄNZEN / COMPLETE CODE

W = LICHTFARBE/LIGHT COLOUR for indirect beam
XX = FARBE/COLOUR BASE
Y = DIMMBAR/DIMMABLE

W white = 05
S black = 06
SM silver matt = 04

S switchable = 0
D DALI dimm = d
EM EMERGENCY 3h = e
EMD EMERGENCY 3h DALI Dimm = f

Superslanke Hängeleuchte aus Aluminium
 Pulverbeschichtet in weiß, schwarz oder silber matt
 Direktabdeckung in opal oder mikropriamatisch
 Dekoring in weiß, silber matt oder schwarz
 Leuchte besteht aus 3 Teilen

Super-slim suspension in aluminium
 white, black or silver matt powder-coated surface
 Recessed direct cover, opal or microprismatic
 white, silver matt or black decoration ring
 Luminaire consists of 3 parts

Lampada a sospensione a ingombro ridotto in alluminio
 Verniciata a polvere in bianco, nero o grigio opaco
 Copertura retrocessa opale o microprismatica
 Anello decorativo in nero, grigio opaco o bianco
 Lampada composta da 3 parti

Suspension extra-fine en aluminium
 Finition laquée blanc, noir ou gris mat
 Diffuseur en retrait opal ou microprismatique
 Anneau décoratif en noir, gris mat ou blanc
 Luminaire composé de trois éléments

EM = UGR <19 (not for Ø 400mm)
TUNABLE WHITE auf Anfrage / on request
W = PMMA opal diffusor
SM = Microprismatic diffusor

2 LEUCHTENKÖRPER / BODY
Betriebsbasis separat ordern / Order base separately
CRI >80 - Binning SDCM 3

SYS 29W	lm W2	lm W3	lm W4	SYS 58W	lm W2	lm W3	lm W4
663-11100101WXXO	2270	2350	2350	663-13100101WXXO	6280	6635	6635
663-11100201WXXO	2275	2355	2355	663-13100201WXXO	5775	5980	5980

SYS 38W (PMMA)	lm W2	lm W3	lm W4	SYS 76W	lm W2	lm W3	lm W4
663-12100101WXXO	3760	3895	3895	663-14100101WXXO	8320	8615	8615
663-12100201WXXO	3365	3485	3485	663-14100201WXXO	8345	8640	8640

ARTIKELNUMMER ERGÄNZEN / COMPLETE CODE

W = LICHTFARBE/LIGHT COLOUR for direct beam
XX = FARBE/COLOUR BODY

W white-white = 55
W white-black = 56
S black-silver matt = 64
S black-white = 65
S black-black = 66

SM silver matt-silver matt = 44
SM silver matt-white = 45
SM silver matt-black = 46
SM white-silver matt = 54

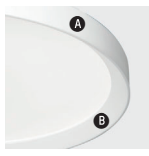

3 EINSPEISUNGSSET / POWER FEED SET

Bestehend aus: Baldachin, Kabel 3000mm, 3 x Seil 3000mm, 3 x Deckenbefestigung
 Contents: ceiling base, cable 3000mm, 3 x wire 3000mm, 3 x ceiling fixation

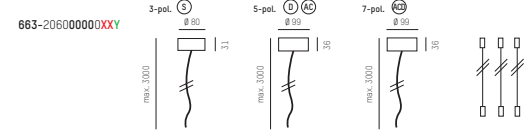

ARTIKELNUMMER ERGÄNZEN / COMPLETE CODE

XX = FARBE/COLOUR CANOPY
Y = DIMMBAR/DIMMABLE

W white = 05
S black = 06
SM silver matt = 04

S switchable = 0
D DALI dimm = d
EMD EMERGENCY 3h DALI Dimm = f

BINA ROUND PD / PDI
Design: INHOUSE

IP20 CE

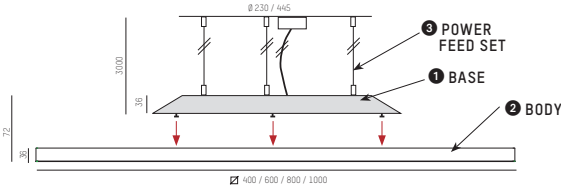

1 BETRIEBSBASIS / BASE
Leuchtenkörper separat ordern / Order body separately

BINA PD BASE
for \square : 400x400 / 600x600mm for direct beam
220-240V AC
663-411010000XXY

BINA PD BASE
for \square : 800x800 / 1000x1000mm for direct beam
220-240V AC
663-431010000XXY

BINA PDI BASE
for \square : 400x400 / 600x600mm for direct-indirect beam
220-240V AC - CRI >80 - Binning SDCM 3
663-41102001WXXY

BINA PDI BASE
for \square : 800x800 / 1000x1000mm for direct-indirect beam
220-240V AC - CRI >80 - Binning SDCM 3
663-43102001WXXY

SYS 15W	lm	w2	lm	w3	lm	w4	SYS 26W	lm	w2	lm	w3	lm	w4
663-41102001WXXY	1365	1415	1415	lm indirect			663-43102001WXXY	3115	3225	3225	lm indirect		

ARTIKELNUMMER ERGÄNZEN / COMPLETE CODE

W = LICHTFARBE/LIGHT COLOUR for indirect beam
XX = FARBE/COLOUR BASE
Y = DIMMBAR/DIMMABLE

w2 LED 2700K = 3
w3 LED 3000K = 9
w4 LED 4000K = 4

W white = 05
S black = 06
SM silver matt = 04

S switchable = 0
D DALI dimm = d
EM EMERGENCY 3h = e
EMD EMERGENCY 3h DALI Dimm = f

Superschlange Hängeleuchte aus Aluminium
Pulverbeschichtet in weiß, schwarz oder silber matt
Direktabdeckung in opal oder mikropriamatisch
Dekoring in weiß, silber matt oder schwarz
Leuchte besteht aus 3 Teilen

Super-slim suspension in aluminium
white, black or silver matt powder-coated surface
Recessed direct cover, opal or microprismatic
white, silver matt or black decoration ring
Luminaire consists of 3 parts

Lampada a sospensione a ingombro ridotto in alluminio
Verniciata a polvere in bianco, nero o grigio opaco
Copertura retroscassa opale o microprismatica
Anello decorativo in nero, grigio opaco o bianco
Lampada composta da 3 parti

Suspension extra-fine in aluminium
Finition laquée blanc, noir ou gris mat
Diffuseur en retrait opal ou microprismatique
Anneau décoratif en noir, gris mat ou blanc
Luminaire composé de trois éléments

= UGR < 19 (not for \square 400mm)
TUNABLE WHITE auf Anfrage / on request
 = PMMA opal diffusor
 = Microprismatic diffusor

A** - **A**
IP20

2 LEUCHTENKÖRPER / BODY

Betriebsbasis separat ordern / Order base separately
CRI >80 - Binning SDCM 3

SYS 29W	lm	w2	lm	w3	lm	w4	SYS 58W	lm	w2	lm	w3	lm	w4
\square : 400x400mm	2680	2775	2775				\square : 800x800mm	6410	6635	6635			
663-21100101WXXO	2680	2775	2775				663-23100101WXXO	6410	6635	6635			
663-21100201WXXO	2685	2780	2780				663-23100201WXXO	6315	6540	6540			

SYS 38W (PMMA)	lm	w2	lm	w3	lm	w4	SYS 33W (MICROPRISMA)	lm	w2	lm	w3	lm	w4
\square : 600x600mm	3745	3875	3875				\square : 1000x1000mm	8530	8835	8835			
663-22100101WXXO	3745	3875	3875				663-24100101WXXO	8530	8835	8835			
663-22100201WXXO	3390	3510	3510				663-24100201WXXO	8430	8730	8730			

ARTIKELNUMMER ERGÄNZEN / COMPLETE CODE

W = LICHTFARBE/LIGHT COLOUR for direct beam
XX = FARBE/COLOUR BODY

w2 LED 2700K = 3
w3 LED 3000K = 9
w4 LED 4000K = 4

A silver matt-silver matt = 44
B silver matt-white = 45
SM silver matt-black = 46
W white-silver matt = 54
W white-white = 55
W white-black = 56
S black-silver matt = 64
S black-white = 65
S black-black = 66

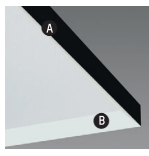

3 EINSPEISUNGSSET / POWER FEED SET

Bestehend aus: Baldachin, Kabel 3000mm, 3 x Seil 3000mm, 3 x Deckenbefestigung
Contents: ceiling base, cable 3000mm, 3 x wire 3000mm, 3 x ceiling fixation

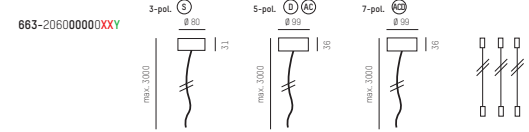

ARTIKELNUMMER ERGÄNZEN / COMPLETE CODE

XX = FARBE/COLOUR CANOPY
Y = DIMMBAR/DIMMABLE

W white = 05
S black = 06
SM silver matt = 04

S switchable = 0
D DALI dimm = d
EM EMERGENCY 3h DALI Dimm = f

BINA SQUARE PD / PDI
Design: INHOUSE



mit Rahmen
with frame

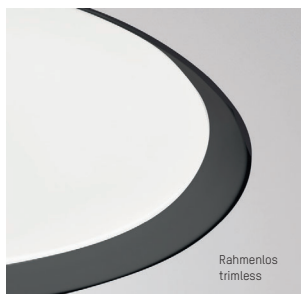

Rahmenlos
trimless

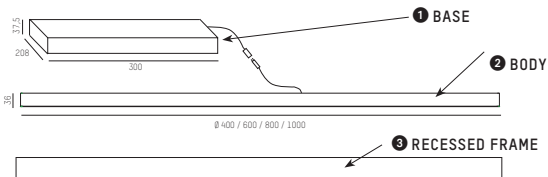

1 BETRIEBSBASIS / BASE

Leuchtenkörper separat ordern / Order body separately

BINA R BASE

for Ø: 400 / 600mm
220-240V AC

663-41201000000Y

BINA R BASE

for Ø: 800 / 1000mm
220-240V AC

663-43201000000Y

ARTIKELNUMMER ERGÄNZEN / COMPLETE CODE

Y = DIMMBAR/DIMMABLE

- Ⓢ switchable = 0 Ⓜ EMERGENCY 3h = e
- Ⓞ DALI dimm = d Ⓜ EMERGENCY 3h DALI Dimm = f

2 LEUCHTENKÖRPER / BODY

Betriebsbasis separat ordern / Order base separately
CRI >80 - Binning SDGM 3

SYS 29W

Ø: 400mm

lm	w2	w3	w4
2270	2350	2350	=
663-11100101WXX0	2275	2355	
663-11100201WXX0	2275	2355	=

SYS 58W (PMMA)

Ø: 800mm

lm	w2	w3	w4
6280	6505	6505	=
663-13100101WXX0	5775	5980	
663-13100201WXX0	5775	5980	=

SYS 51W (MICROPRISMA)

Ø: 800mm

lm	w2	w3	w4
6280	6505	6505	=
663-13100101WXX0	5775	5980	
663-13100201WXX0	5775	5980	=

SYS 38W (PMMA)

Ø: 600mm

lm	w2	w3	w4
3760	3895	3895	=
663-12100101WXX0	3365	3485	
663-12100201WXX0	3365	3485	=

SYS 33W (MICROPRISMA)

Ø: 600mm

lm	w2	w3	w4
3760	3895	3895	=
663-12100101WXX0	3365	3485	
663-12100201WXX0	3365	3485	=

SYS 76W

Ø: 1000mm

lm	w2	w3	w4
8320	8615	8615	=
663-14100101WXX0	8345	8640	
663-14100201WXX0	8345	8640	=

ARTIKELNUMMER ERGÄNZEN / COMPLETE CODE

W = LICHTFARBE/LIGHT COLOUR

w2	LED 2700K = 3
w3	LED 3000K = 9
w4	LED 4000K = 4

XX = FARBE/COLOUR BODY

A	B	Color	Code
SM	SM	silver matt-silver matt	44
SM	W	silver matt-white	45
SM	S	silver matt-black	46
W	SM	white-silver matt	54
W	W	white-white	55
W	S	white-black	56
S	SM	black-silver matt	64
S	W	black-white	65
S	S	black-black	66



Superschlange Einbauleuchte aus Aluminium
Pulverbeschichtet in weiß, schwarz oder silber matt
Direktabdeckung in opal oder mikropismatisch
Dekoring in weiß, silber matt oder schwarz
Leuchte besteht aus 3 Teilen

Super-slim recessed luminaire in aluminium
white, black or silver matt powder-coated surface
Recessed direct cover, opal or microprismatic
white, silver matt or black decoration ring
Luminaire consists of 3 parts

Lampada ad incasso a ingombro ridotto in alluminio
Verniciata a polvere in bianco, nero o grigio opaco
Copertura retrocessa opale o microprismatica
Anello decorativo in nero, grigio opaco o bianco
Lampada composta da 3 parti

Encastré extra-fin en aluminium
Finition laquée blanc, noir ou gris mat
Diffuseur en retrait opal ou microprismatique
Anneau décoratif en noir, gris mat ou blanc
Luminaire composé de trois éléments

= UGR<19 (not for Ø 400mm)

TUNABLE WHITE auf Anfrage / on request

= PMMA opal diffusor

= Microprismatic diffusor

A** - A

IP 20



3 EINBAURAHMEN / RECESSED FRAME

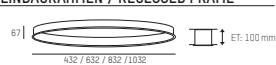

663-11300000XX0	DA: Ø 408 for Ø 400mm
663-12300000XX0	DA: Ø 608 for Ø 600mm
663-13300000XX0	DA: Ø 808 for Ø 800mm
663-14300000XX0	DA: Ø 1008 for Ø 1000mm

3 EINBAURAHMEN TRIMLESS RECESSED FRAME TRIMLESS



663-114000000050	W	DA: Ø 408 for Ø 400mm
663-124000000050	W	DA: Ø 608 for Ø 600mm
663-134000000050	W	DA: Ø 808 for Ø 800mm
663-144000000050	W	DA: Ø 1008 for Ø 1000mm

ARTIKELNUMMER ERGÄNZEN / COMPLETE CODE

XX = FARBE/COLOUR FRAME

SM	silver matt = 04
W	white = 05
S	black = 06



mit Rahmen
with frame

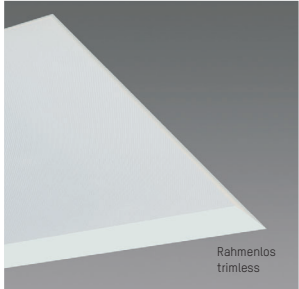

Rahmenlos
trimless

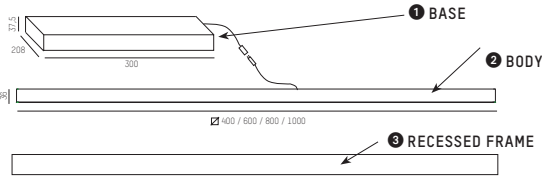

1 BETRIEBSBASIS / BASE

Leuchtenkörper separat ordern / Order body separately

BINA R BASE

for \square : 400x400 / 600x600mm
220-240V AC/DC

663-41201000000Y

BINA R BASE

for \square : 800x800 / 1000x1000mm
220-240V AC/DC

663-43201000000Y

ARTIKELNUMMER ERGÄNZEN / COMPLETE CODE

Y = DIMMBAR/DIMMABLE

- ③ switchable = 0 ④ EMERGENCY 3h = e
- ① DALI dimm = d ④ EMERGENCY 3h DALI Dimm = f

2 LEUCHTENKÖRPER / BODY

Betriebsbasis separat ordern / Order base separately
CRI >80 - Binning SDCM 3

SYS 29W

\square : 400x400mm

	lm	w2	lm	w3	lm	w4
663-21100101WXX0	2680	2775	2775			
663-21100201WXX0	2685	2780	2780			

SYS 58W

\square : 800x800mm

	lm	w2	lm	w3	lm	w4
663-23100101WXX0	6410	6635	6635			
663-23100201WXX0	6315	6540	6540			

SYS 38W (PMMA)

\square : 600x600mm

	lm	w2	lm	w3	lm	w4
663-22100101WXX0	3745	3875	3875			
663-22100201WXX0	3390	3510	3510			

SYS 33W (MICROPRISMA)

\square : 600x600mm

	lm	w2	lm	w3	lm	w4
663-22100101WXX0	3745	3875	3875			
663-22100201WXX0	3390	3510	3510			

SYS 76W

\square : 1000x1000mm

	lm	w2	lm	w3	lm	w4
663-24100101WXX0	8530	8835	8835			
663-24100201WXX0	8430	8730	8730			

ARTIKELNUMMER ERGÄNZEN / COMPLETE CODE

W = LICHTFARBE/LIGHT COLOUR

w2	LED 2700K = 3
w3	LED 3000K = 9
w4	LED 4000K = 4

XX = FARBE/COLOUR BODY

A	SM	SM	silver matt-silver matt = 44
A	SM	W	silver matt-white = 45
A	SM	S	silver matt-black = 46
W	SM	SM	white-silver matt = 54
W	SM	W	white-white = 55
W	SM	S	white-black = 56
S	SM	SM	black-silver matt = 64
S	SM	W	black-white = 65
S	SM	S	black-black = 66

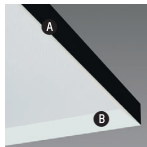

Superschlankes Einbauleuchte aus Aluminium
Pulverbeschichtet in weiß, schwarz oder silber matt
Direktabdeckung in opal oder mikropriamatisch
Dekoring in weiß, silber matt oder schwarz
Leuchte besteht aus 3 Teilen

Super-slim recessed luminaire in aluminium
white, black or silver matt powder-coated surface
Recessed direct cover, opal or microprismatic
white, silver matt or black decoration ring
Luminaire consists of 3 parts

Lampada ad incasso a ingombro ridotto in alluminio
Verniciata a polvere in bianco, nero o grigio opaco
Copertura retrocessa opale o microprismatica
Anello decorativo in nero, grigio opaco o bianco
Lampada composta da 3 parti

Encastré extra-fin en aluminium
Finition laquée blanc, noir ou gris mat
Diffuseur en retrait opal ou microprismatique
Anneau décoratif en noir, gris mat ou blanc
Luminaire composé de trois éléments

UGR < 19 (not for \square 400mm)

TUNABLE WHITE auf Anfrage / on request

PMMA opal diffusor

Microprismatic diffusor

A** - A

IP 20 CE



3 EINBAURAHMEN / RECESSED FRAME

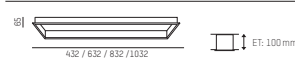

663-213000000XX0	DA: \square 408 for \square 400mm
663-223000000XX0	DA: \square 608 for \square 600mm
663-233000000XX0	DA: \square 808 for \square 800mm
663-243000000XX0	DA: \square 1008 for \square 1000mm

3 EINBAURAHMEN TRIMLESS RECESSED FRAME TRIMLESS



663-214000000050	W	DA: \square 408 for \square 400mm
663-224000000050	W	DA: \square 608 for \square 600mm
663-234000000050	W	DA: \square 808 for \square 800mm
663-244000000050	W	DA: \square 1008 for \square 1000mm

ARTIKELNUMMER ERGÄNZEN / COMPLETE CODE

XX = FARBE/COLOUR FRAME

SM	silver matt = 04
W	white = 05
S	black = 06