

# UDON 1220



## Physical

**Material** Silicone with Silicone Opal diffuser

**Mounting type** Surface mounted

**Power Feeds** Multiple types depending on application

## Features

1 - Cuttable

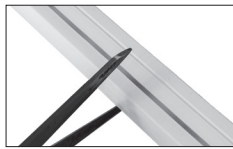

## Electrical

**Voltage and Current** 24VDC

**Control** Non-dimmable, Triac, 1-10V, DALI

**Max Run Per Power Feed**  
10m single power feed  
20m dual power feed

2 - Seamless Joinable

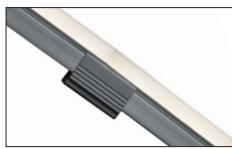

## Optical

**Beam angle** 120°

**CCT** 2700, 3000, 4000, 6000K, RGB, RGB Pixel

**CRI** 80, 90 (on request)

3 - Power Feeds

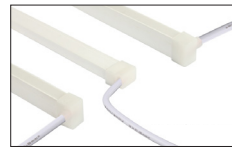

## Certification

**Warranty** 2 years

**Category** IP65

## Product Specification

SKU	Wattage (per m)	Lumen Output (per m) (2700K/3000K/4000K/6000k) (R/G/B)	Cuttable	Minimum Bend Radius	Dimensions WxH mm	Technical Drawing
FU1220	14.4 W	196/205/282/324 lm	100 mm	100 mm	12 x 20	
FU1220-RGB	14.4 W	24/52/13 lm	100 mm	100 mm	12 x 20	
FU1220-RGBP	10 W	24/52/13 lm	100 mm	100 mm	12 x 20	

## Package

Udon 1220 is sold in a 10m pack with pre-attached Power Feed Bottom and End Cap. This pack also includes multiple accessories for most applications.

SKU	SKU per package
FU1220 / FU1220-RGB / FU1220-RGBP	1 x 10 m
FU1220-EC	4
FU1220-PFL	1
FU1220-PFR	1
FU1220-PFB	1
FU1220-MC	10

1 x 20 ml of Silicone Glue included in UDON package

## Accessories

If additional accessories are required for a project please consult Novii.

SKU	Name	Technical Drawing
FU1220 / FU1220-RGB / FU1220-RGBP	UDON 1220	See Product Spec
FU1220-EC	End Caps	
FU1220-PFL	Power Feed Left	
FU1220-PFR	Power Feed Right	
FU1220-PFB	Power Feed Bottom	
FU1220-MC	Mounting Clip	
FU1220-MC-1M	Mounting Profile (1M Length)	