

Installation Instructions Commercial Fixed Downlight

Product information

The Novii Commercial Fixed Downlight is a recessed ceiling fixture available in several colours, wattages, different beam angles and dimming options to suit most projects.

Installation steps

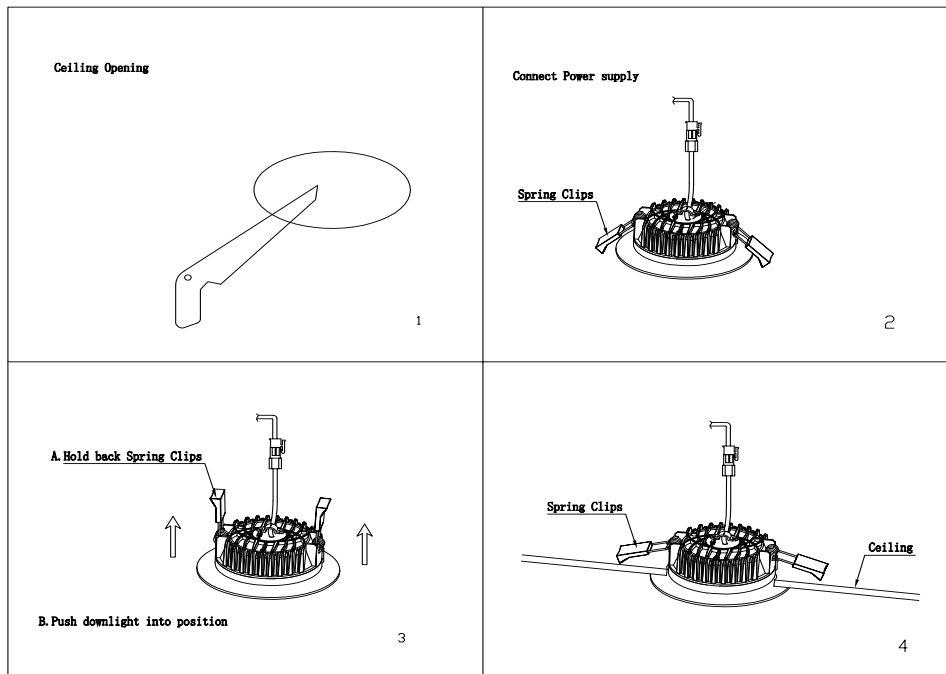

Technical specifications

Model	Dimension	Cut-out	Power (W)	CCT (K)	PF	IP	Voltage	Dimmable
F18SD	Ø145mm x H46mm	Ø120-130 mm	18	2700 - 6000	> 0.9	44	AC220-240V 50/60Hz	Non-dim Triac dim 1-10V DALI
F25SD	Ø170mm x H46mm	Ø140-150 mm	25	2700 - 6000	> 0.9	44	AC220-240V 50/60Hz	
F35SD	Ø190mm x H46mm	Ø160-170 mm	35	2700 - 6000	> 0.9	44	AC220-240V 50/60Hz	

Note : Please check downlight label to see if fitting is dimmable and if so which type of dimming.

Regulations

To ensure correct functionality and safety please read instructions carefully before using this product. This luminaire complies with AS/NZS 60598.2.2A.

All wiring and installation of this luminaire must adhere to local and national wiring rules eg AS/NZS 3000:2007 Amendment 2:2012 Electrical Installation

TIPS

1. Always ensure power is off and the fitting has cooled down before performing any maintenance or adjustment to the fitting
2. To avoid injury or damage to the fitting, ensure that power leads and screws are secure before connecting the power
3. Handle the fitting with care to avoid breakage
4. Find a suitable location away from liquids or hazards
5. To clean, wipe with a damp clean cloth. Never soak the fitting with water.