

Installation Instructions Surface Mounted LED Downlight

Product information

The Novii Surface Mounted LED Downlight is a ceiling surface mounted fixture available in several wattages, colours and dimming options to suit most projects.

Installation steps

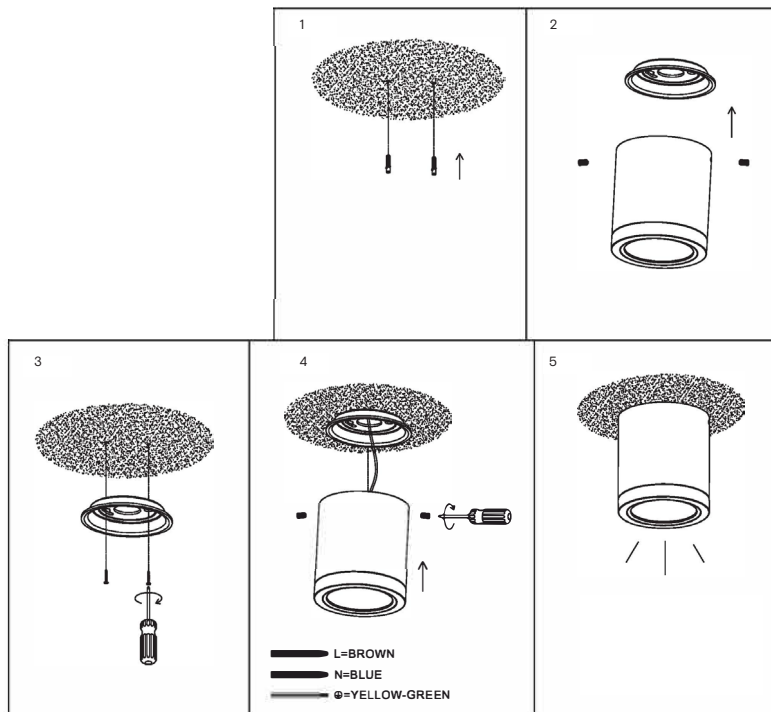

1. Take out anchor nuts from the accessory bag and attach to ceiling
2. Loosen mounting bracket
3. Fix mounting bracket on the ceiling with screw
4. Open the junction box, connect correctly "L", "N", "G" then mount lamp to bracket

Technical specifications

Model	Dimension	Power (W)	CCT (K)	PF	IP	Voltage	Control
F15RSM	Ø90mm x H100mm	15	2700 - 5000	> 0.9	54	AC220-240V 50/60Hz	Non-dim Triac dim
F25RSM	Ø120mm x H110mm	25	2700 - 5000	> 0.9	54	AC220-240V 50/60Hz	
F35RSM	Ø120mm x H160mm	35	2700 - 5000	> 0.9	54	AC220-240V 50/60Hz	
F10ASM	Ø90mm x H110mm	10	2700 - 5000	> 0.9	20	AC220-240V 50/60Hz	
F20ASM	Ø115mm x H122mm	20	2700 - 5000	> 0.9	20	AC220-240V 50/60Hz	
F10SSM	Ø90mm x H110mm	10	2700 - 5000	> 0.9	20	AC220-240V 50/60Hz	
F20SSM	Ø115mm x H122mm	20	2700 - 5000	> 0.9	20	AC220-240V 50/60Hz	

Note : Please check downlight label to see if fitting is dimmable and if so which type of dimming.

Regulations

To ensure correct functionality and safety please read instructions carefully before using this product. This luminaire complies with AS/NZS 60598.2.2A.

All wiring and installation of this luminaire must adhere to local and national wiring rules eg AS/NZS 3000:2007 Amendment 2:2012 Electrical Installation

TIPS

1. Always ensure power is off and the fitting has cooled down before performing any maintenance or adjustment to the fitting
2. To avoid injury or damage to the fitting, ensure that power leads and screws are secure before connecting the power
3. Handle the fitting with care to avoid breakage
4. Find a suitable location away from liquids or hazards
5. To clean, wipe with a damp clean cloth. Never soak the fitting with water.