

Universal Batten



Regulations

To ensure correct functionality and safety please read instructions carefully before using this product. This luminaire complies with AS/NZS 60598.2.1. All wiring and installation of this luminaire must adhere to local and national wiring rules e.g. AS/NZS 3000:2007 Amendment 2:2012 Electrical Installation.

Tips

1. Always ensure power is off and the fitting has cooled down before performing any maintenance or adjustment to the fitting
2. To avoid injury or damage to the fitting, ensure that power leads and screws are secure before connecting the power

3. Handle the fitting with care to avoid breakage
4. Find a suitable location away from liquids or hazards
5. To clean, wipe with a damp clean cloth. Never soak the fitting with water.

Note: Please check fitting label to see if fitting is dimmable and if so which type of dimming.

Warning

1. Switch off power before installation
2. Switch on only after complete installation and examination of the circuit
3. Only a qualified electrician can install and maintain this fitting
4. Product modification and/or improper installation will void warranty.

Installation

A. Isolate the mains supply before connecting. Unpack the luminaire and check that you have all the tools to install the luminaire safely and in compliance with current electrical standards. Ensure there are no obstructions or services in the way.

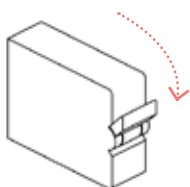

B. Remove the diffuser from the fitting.

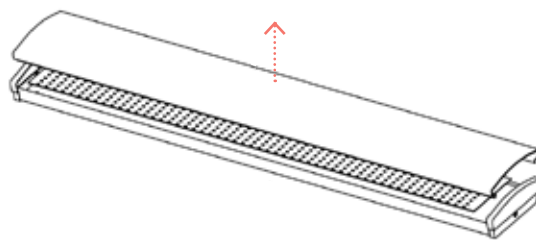

C. Feed the mains cable through the back of the fitting.



D. Terminate the mains cable into the 3-way terminal block. Ensure that the correct polarity is observed and the luminaire is fully earthed. Ensure all conductors are fully sleeved and insulated.

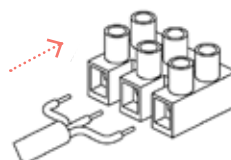

RoHS



CE

IP20

IP44

grace

Installation continued...

E. Hold the fitting up to the ceiling in the desired position and mark hole fixing centres.



F. Drill fixing holes. Insert rawl plugs. Fix in position with fixings.

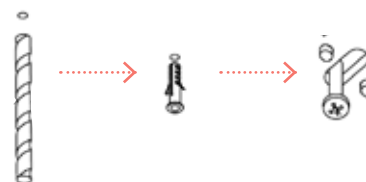

I. Replace the diffuser into the fitting.

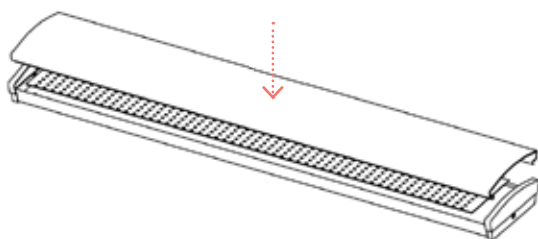

J. Turn on mains power supply and test luminaire for correct operation.

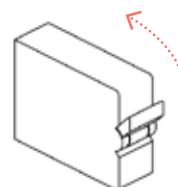

Model	Dimensions LxWxH mm	Power (W)	CCT (K)	IP	Voltage (AC)	Control
G40BC	1200 x 208 x 70	40	3000, 4000, 5000	44	220-240V 50,60Hz	Non-dim, 1-10V, DALI
G60BC	1500 x 208 x 70	60	3000, 4000, 5000	44	220-240V 50,60Hz	Non-dim, 1-10V, DALI
G80BC	1800 x 208 x 70	80	3000, 4000, 5000	44	220-240V 50,60Hz	Non-dim, 1-10V, DALI
G40BS	1200 x 175 x 70	40	3000, 4000, 5000	44	220-240V 50,60Hz	Non-dim, 1-10V, DALI
G60BS	1500 x 175 x 70	60	3000, 4000, 5000	44	220-240V 50,60Hz	Non-dim, 1-10V, DALI
G80BS	1800 x 175 x 70	80	3000, 4000, 5000	44	220-240V 50,60Hz	Non-dim, 1-10V, DALI
G40BR	1200 x 180 x 103	40	3000, 4000, 5000	44	220-240V 50,60Hz	Non-dim, 1-10V, DALI
G60BR	1500 x 180 x 103	60	3000, 4000, 5000	44	220-240V 50,60Hz	Non-dim, 1-10V, DALI
G80BR	1800 x 180 x 103	80	3000, 4000, 5000	44	220-240V 50,60Hz	Non-dim, 1-10V, DALI
G22BRS	1181 x 50 x 56	22	3000, 4000, 5000	20	220-240V 50,60Hz	Non-dim, 1-10V, DALI
G32BRS	1481 x 50 x 56	32	3000, 4000, 5000	20	220-240V 50,60Hz	Non-dim, 1-10V, DALI
G50BRS	1881 x 50 x 56	50	3000, 4000, 5000	20	220-240V 50,60Hz	Non-dim, 1-10V, DALI