

## Installation Instructions Tubular Tracklight

### Product information

The Novii tracklight is a 3 circuit track mounted/surface mounted fixture available in different colours and wattages to suit most projects.

### Installation steps

#### Track mounted

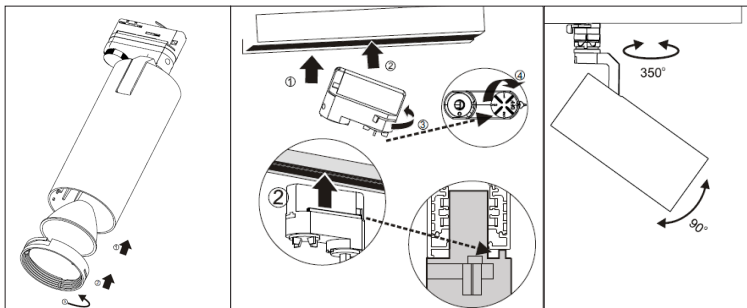

1. Switch off before installation, mount track to ceiling with mounting clips.
  2. Connect track terminal block with "L", "N", "G" properly.
  3. Insert fixture track adaptor into track making sure the two data bus contacts are on the same side as the data rail on the track.
- Follow the steps below :
- Align the adaptor and contacts parallel with track.
  - Pull down latch on adaptor and insert adaptor into track.
- (Note : Twist the adaptor and ground contact toward the polarity groove)
- Support the fixture with one hand and twist the adaptor 1/4 turn till the latch locks into the track.
4. Adjust tracklight towards target object both vertically and horizontally. Switch on and test for correct operation.

#### Surface mounted

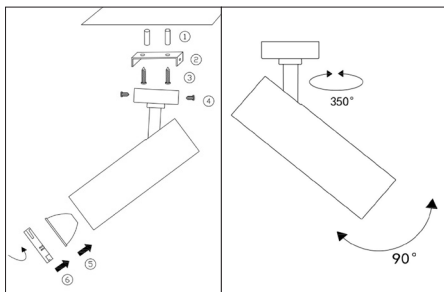

### Technical specifications

Model	Dimension	Power (W)	CCT (K)	PF	IP	Voltage	Dimmable
F12T	Ø75mm x H240mm	12	2700 - 6500 + Sunset dim	> 0.9	20	AC220-240V 50/60Hz	Non-dim Triac dim Sunset dim
F12TSM	Ø75mm x H230mm	12	2701 - 6500 + Sunset dim	> 0.9	20	AC220-240V 50/60Hz	
F28T	Ø83.5mm x H260.2mm	28	2700 - 6500	> 0.9	20	AC220-240V 50/60Hz	
F28TSM	Ø83.5mm x H225mm	28	2700 - 6500	> 0.9	20	AC220-240V 50/60Hz	
F28TA	Ø75mm x H310mm	28	2700 - 6500	> 0.9	20	AC220-240V 50/60Hz	
F28TSMA	Ø75mm x H250mm	28	2700 - 6500	> 0.9	20	AC220-240V 50/60Hz	
F40T	Ø98mm x H285.2mm	40	2700 - 6500	> 0.9	20	AC220-240V 50/60Hz	
F28TRF	L204mm x I75mm x H250 mm	28	2700 - 5000	> 0.9	20	AC220-240V 50/60Hz	
F38TRF	L204mm x I75mm x H250 mm	38	2700 - 5000	> 0.9	20	AC220-240V 50/60Hz	
F48TRF	L204mm x I75mm x H250 mm	48	2700 - 5000	> 0.9	20	AC220-240V 50/60Hz	

Note : Please check batten label to see if fitting is dimmable and if so which type of dimming.

### Regulations

To ensure correct functionality and safety please read instructions carefully before using this product. This luminaire complies with AS/NZS 60598.2.1.

All wiring and installation of this luminaire must adhere to local and national wiring rules eg AS/NZS 3000:2007 Amendment 2:2012 Electrical Installation

### TIPS

1. Always ensure power is off and the fitting has cooled down before performing any maintenance or adjustment to the fitting
2. To avoid injury or damage to the fitting, ensure that power leads and screws are secure before connecting the power
3. Handle the fitting with care to avoid breakage
4. Find a suitable location away from liquids or hazards
5. To clean, wipe with a damp clean cloth. Never soak the fitting with water.